

TRUSTLENE Electrofusion Fittings



Advantages at a glance

- ✓ High performance in extreme situations
- ✓ Corrosion-free; practically maintenance-free
- ✓ Quick and easy to install
- ✓ Leak-proof, robust jointing
- ✓ Products are tested to meet water standards.

Materials	
Product	Material
All fittings	Polyethylene PE100

Fittings specifications

Specification		
Material	PE100	
Colour	Black	
Melt flow index (5kg/190°C)	0.25 g/10min	ISO 1133
Density	- 960 kg/m ³	ISO 1183
Yield stress at 23°C (50mm/min)	25 MPa	ISO 527
Elastic modulus at 23°C	1100 MPa	ISO 527
Elongation at break 23°C	> 600%	ISO 6259
Hydrostatic strength at 20°C	> 100h	ISO 1167
Coefficient of linear thermal expansion at 20°C	0.15 - 0.20 mm/m.C	
Standards	MS 1058 : PART 3 : 2006	
Terminal pin diameter	4.0mm	
Fittings' maximum power requirement	2.5 kW	
Fittings' voltage supply	39 to 40 V rms	
Packaging	Fittings are bagged	
Marking and labeling	To ensure traceability, all fittings are permanently marked with identification during the production process. <ul style="list-style-type: none"> • Brand name • Dimensions • Material and designation • SDR fusion range 	

Normative references

- MS 1058 : PART 3 – Polyethylene (PE) Piping Systems For Water Supply – Part 3 : Fittings
- ISO 4427 : PART 3 – Plastics piping Systems – Polyethylene (PE) pipes and fittings for water supply – Part 3: Fittings
- EN 12201 : PART 3 – Plastics piping Systems for water supply – Polyethylene (PE) – Part 3: Fittings

*Standards & Approval:



*All standards and approvals certification available upon request.

TRUSTLENE Electrofusion Fittings

ELECTROFUSION COUPLER

Material: PE100 | Colour: Black | Terminal Pin: 4.0mm | SDR 11 | PN 16

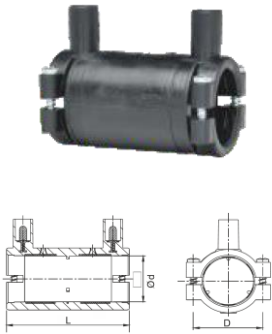

ELECTROFUSION COUPLER WITH INTEGRAL CLAMPING

Product Code	d [mm]	D [mm]	L [mm]	Approx. Wt. gm [pc]	Fusion time (s)	Cooling time (m)	Std packing* [qty]
51121212020	20	31	77	53	22	4	175
51121212025	25	36	79	63	28	4	150
51121212032	32	44	82	75	42	4	100
51121212040	40	53	83	96	52	7	80
51121212050	50	65	105	141	55	7	54
51121212063	63	81	110	220	70	7	35

Material: PE100 | Colour: Black | Terminal Pin: 4.0mm | SDR 11 | PN 16

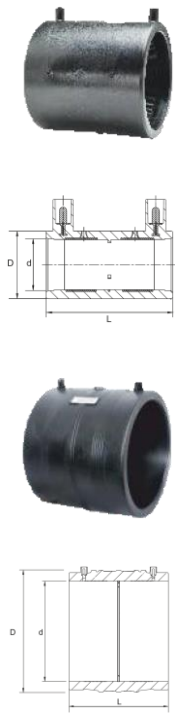

ELECTROFUSION COUPLER

Product Code	d [mm]	D [mm]	L [mm]	Approx. Wt. gm [pc]	Fusion time (s)	Cooling time (m)	Std packing* [qty]
51121112020	20	31	70	44	22	4	250
51121112025	25	36	70	53	28	4	175
51121112032	32	44	75	68	42	4	150
51121112040	40	53	75	67	52	7	125
51121112050	50	65	90	133	55	7	60
51121112063	63	81	100	133	70	7	35
51121112075	75	91	100	221	80	7	35
51121112090	90	113	133	496	140	15	14
51121112110	110	138	152	799	160	15	11
51121112125	125	155	167	1150	200	15	8
51121412140	140	165	165	1060	240	20	7
51121412160	160	189	180	1440	380	20	12
51121412180	180	213	190	1850	400	20	9
51121412200	200	236	183	2160	480	20	6
51121412225	225	266	232	3470	690	30	4
51121412250	250	295	244	4170	840	40	1
51121412280	280	331	258	5520	650	40	2
51121412315	315	372	274	7410	840	40	1

Material: PE100 | Colour: Black | Terminal Pin: 4.0mm | SDR 17 | PN 10



ELECTROFUSION COUPLER

Product Code	d [mm]	D [mm]	L [mm]	Approx. Wt. gm [pc]	Fusion time (s)	Cooling time (m)	Std packing* [qty]
51121312140	140	161	165	774.2	175	20	7
51121312160	160	183	180	1176	290	20	12
51121312180	180	206	190	1351	290	20	9
51121312200	200	229	183	1749	480	20	2
51121312225	225	256	232	2667	690	30	2
51121312250	250	284	244	3265	840	40	2
51121312280	280	316	258	4251	650	40	2
51121312315	315	357	274	6040	840	40	2

TRUSTLENE Electrofusion Fittings

ELECTROFUSION REDUCER

Material: PE100 | Colour: Black | Terminal Pin: 4.0mm | SDR 11 | PN 16

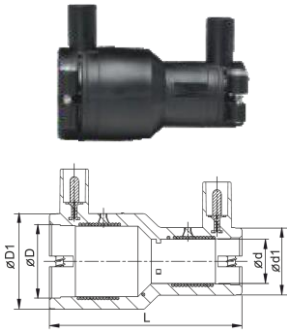

ELECTROFUSION REDUCER WITH INTEGRAL CLAMPING

Product Code	D x d [mm]	D1 [mm]	d1 [mm]	L [mm]	Approx. Wt. gm [pc]	Fusion time (s)	Cooling time (m)	Std packing* [qty]
51131132031	25 x 20	36	31	87	62	26	4	140
51131132062	32 x 20	44	31	89	75	34	4	120
51131132063	32 x 25	44	36	89	75	30	4	120
51131132093	40 x 20	53	31	100	88	30	7	90
51131132094	40 x 25	53	36	100	92	30	7	90
51131132095	40 x 32	53	44	94	97	42	7	80
51131132125	50 x 25	65	36	110	103	30	7	60
51131132126	50 x 32	65	44	110	109	36	7	60
51131132127	50 x 40	65	53	110	118	46	7	60
51131132157	63 x 32	81	44	106	173	47	7	42
51131132158	63 x 40	81	53	119	187	42	7	36
51131132159	63 x 50	81	65	120	205	45	7	36

Material: PE100 | Colour: Black | Terminal Pin: 4.0mm | SDR 11 | PN 16

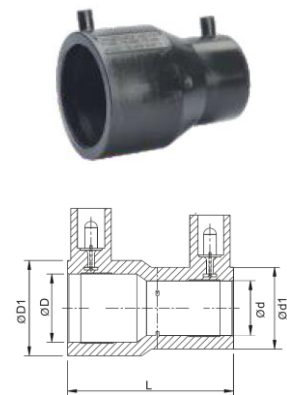

ELECTROFUSION REDUCER

Product Code	D x d [mm]	D1 [mm]	d1 [mm]	L [mm]	Approx. Wt. gm [pc]	Fusion time (s)	Cooling time (m)	Std packing* [qty]
51131112031	25 x 20	37	31	75	51	26	4	140
51131112062	32 x 20	44	31	82	64	34	4	120
51131112063	32 x 25	44	37	82	67	30	4	120
51131112095	40 x 32	53	44	94	88	42	7	100
51131112157	63 x 32	81	44	106	174	47	7	42
51131112158	63 x 40	81	53	115	174	42	7	36
51131112159	63 x 50	81	65	115	199	45	7	36
51131112191	75 x 63	94	81	120	263	90	7	24
51131112222	90 x 63	113	81	150	489	75	15	14
51131112223	90 x 75	113	94	200	451	100	15	14
51131112253	110 x 63	137	81	180	703	150	15	8
51131112254	110 x 75	137	94	160	627	150	15	10
51131112255	110 x 90	137	113	171	751	185	15	8
51131112284	125 x 63	155	81	200	928	95	15	8
51131112285	125 x 75	155	94	160	738	95	15	8
51131112286	125 x 90	155	113	200	987	140	15	8
51131112287	125 x 110	155	136	170	904	140	15	8

Material: PE100 | Colour: Black | Terminal Pin: 4.0mm | SDR 17 | PN 10



ELECTROFUSION REDUCER (KIT)

Product Code	D x d [mm]	D1 [mm]	Fusion time (s)	Cooling time (m)	d1 [mm]	Fusion time (s)	Cooling time (m)	L [mm]	Approx. Wt. gm [pc]	Std packing* [qty]
51131312317	140 x 90	165	175	20	113	140	15	367	2537	5
51131312318	140 x 110	165	175	20	138	160	15	387	3018	5
51131312319	140 x 125	165	175	20	155	200	15	388	3457	5
51131312348	160 x 90	189	290	20	113	140	15	398	3301	4
51131312349	160 x 110	189	290	20	138	160	15	416	3664	4
51131312350	160 x 125	189	290	20	155	200	15	424	4177	4
51131312351	160 x 140	189	290	20	170	240	20	427	4270	4
51131312380	180 x 110	213	290	20	138	160	15	432	4387	2
51131312381	180 x 125	213	290	20	155	200	15	440	4796	2
51131312383	180 x 160	213	290	20	193	380	20	459	5653	2
51131312411	200 x 110	236	480	20	138	160	15	467	5261	2
51131312413	200 x 140	236	480	20	170	240	20	476	5829	2
51131312414	200 x 160	236	480	20	193	380	20	490	6219	2
51131312415	200 x 180	236	480	20	215	400	20	506	6924	2
51131312442	225 x 110	266	690	30	138	160	20	503	7147	1
51131312445	225 x 160	266	690	30	193	380	20	515	8109	1
51131312446	225 x 180	266	690	30	215	400	20	526	8836	1
51131312447	225 x 200	266	690	30	246	480	20	562	9528	1
51131312476	250 x 160	295	840	40	193	380	20	537	9627	1
51131312477	250 x 180	295	840	40	215	400	20	559	10708	1
51131312478	250 x 200	295	840	40	246	480	20	579	11116	1
51131312479	250 x 225	295	840	40	277	690	30	590	12708	1
51131312508	280 x 180	331	650	40	215	400	20	627	13190	1
51131312509	280 x 200	331	650	40	246	480	20	642	13828	1
51131312510	280 x 225	331	650	40	277	690	30	646	15350	1
51131312541	315 x 225	372	840	40	277	690	30	707	19182	1
51131312542	315 x 250	372	840	40	292	840	40	714	20596	1
51131312543	315 x 280	372	840	40	342	840	40	719	22508	1

TRUSTLENE Electrofusion Fittings

ELECTROFUSION ELBOW 90°

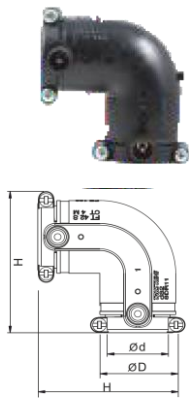

Material: PE100 | Colour: Black | Terminal Pin: 4.0mm | SDR 11 | PN 16

ELECTROFUSION ELBOW 90° WITH INTEGRAL CLAMPING

Product Code	d [mm]	D [mm]	H [mm]	Approx. Wt. gm [pc]	Fusion time (s)	Cooling time (m)	Std packing* [qty]
51151132020	20	31	76	63	22	4	120
51151132025	25	36	78	70	28	4	100
51151132032	32	44	86	90	42	4	75
51151132040	40	53	101	141	52	7	48
51151132050	50	65	115	135	55	7	30
51151132063	63	81	130	315	70	7	20

Material: PE100 | Colour: Black | Terminal Pin: 4.0mm | SDR 11 | PN 16

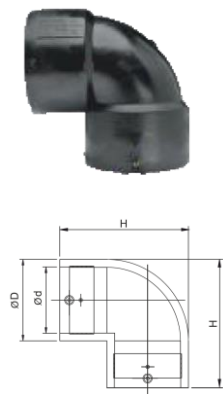

ELECTROFUSION ELBOW 90°

Product Code	d [mm]	D [mm]	H [mm]	Approx. Wt. gm [pc]	Fusion time (s)	Cooling time (m)	Std packing* [qty]
51151112020	20	33	70	35	22	4	168
51151112025	25	35	71	35	28	4	120
51151112032	32	44	75	48	42	4	100
51151112040	40	53	92	117	52	7	60
51151112063	63	82	122	290	70	7	21
51151112075	75	94	137	401	80	7	15
51151112090	90	113	172	655	140	15	8
51151112110	110	137	209	806	160	15	4
51151112125	125	155	230	1529	200	15	4

Material: PE100 | Colour: Black | Terminal Pin: 4.0mm | SDR 17 | PN 10

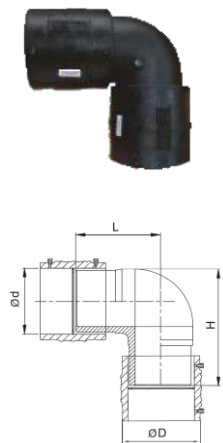

ELECTROFUSION ELBOW 90°

Product Code	d [mm]	D [mm]	H [mm]	L [mm]	Approx. Wt. gm [pc]	Fusion time (s)	Cooling time (m)	Std packing* [qty]
51151512140	140	165	250	195	4586	240	20	3
51151512160	160	189	273	205	6104	380	20	2
51151512180	180	213	290	225	8000	400	20	2
51151512200	200	236	311	245	10432	480	30	1
51151512225	225	266	341	264	14220	690	30	1
51151512250	250	295	368	284	19200	840	40	1
51151512280	280	331	406	327	27042	650	40	1
51151512315	315	372	430	358	36890	840	40	1

TRUSTLENE Electrofusion Fittings

ELECTROFUSION ELBOW 45°



Material: PE100 | Colour: Black | Terminal Pin: 4.0mm | SDR 11 | PN 16

ELECTROFUSION ELBOW 45° WITH INTEGRAL CLAMPING

Product Code	d [mm]	D [mm]	H [mm]	L [mm]	Approx. Wt. gm [pc]	Fusion time (s)	Cooling time (m)	Std packing* [qty]
51151332020	20	31	87	55	55	22	4	140
51151332025	25	36	96	61	72	28	4	85
51151332032	32	44	101	80	85	42	4	85
51151332040	40	53	116	93	125	52	7	60
51151332050	50	65	130	105	181	55	7	30
51151332063	63	81	153	128	303	70	7	24



Material: PE100 | Colour: Black | Terminal Pin: 4.0mm | SDR 11 | PN 16

ELECTROFUSION ELBOW 45°

Product Code	d [mm]	D [mm]	H [mm]	L [mm]	Approx. Wt. gm [pc]	Fusion time (s)	Cooling time (m)	Std packing* [qty]
51151312075	75	94	152	130	352	80	7	18
51151312090	90	113	192	160	661	140	15	8

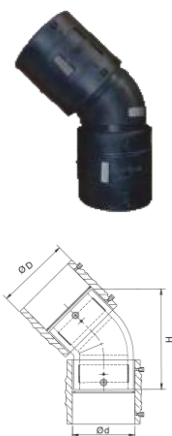

Material: PE100 | Colour: Black | Terminal Pin: 4.0mm | SDR 17 | PN 10

ELECTROFUSION ELBOW 45°

Product Code	d [mm]	D [mm]	H [mm]	Approx. Wt. gm [pc]	Fusion time (s)	Cooling time (m)	Std packing* [qty]
51151712110	110	138	220	2549	160	15	3
51151712125	125	155	239	3590	200	15	3
51151712140	140	165	250	4165	240	20	3
51151712160	160	189	273	5189	380	20	3
51151712180	180	213	290	7213	400	20	2
51151712200	200	236	311	8236	480	30	1
51151712225	225	266	341	12266	690	30	1
51151712250	250	295	368	16295	840	40	1
51151712280	280	331	406	22311	650	40	1
51151712315	315	372	430	30372	840	40	1

TRUSTLENE Electrofusion Fittings

ELECTROFUSION END CAP

Material: PE100 | Colour: Black | Terminal Pin: 4.0mm | SDR 17 | PN 10

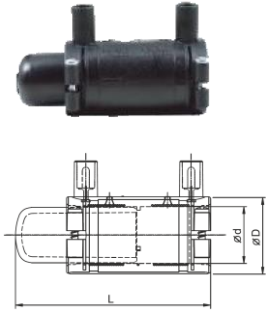

ELECTROFUSION IC END CAP							
Product Code	d [mm]	D [mm]	L [mm]	Approx. Wt. gm [pc]	Fusion time (s)	Cooling time (m)	Std packing* [qty]
51181212020	20	31	103	53	22	4	140
51181212025	25	36	105	78	28	4	120
51181212032	32	44	109	95	42	4	85
51181212040	40	53	119	131	52	7	40
51181212050	50	65	142	202	55	7	36
51181212063	63	81	158	326	70	7	24

Material: PE100 | Colour: Black | Terminal Pin: 4.0mm | SDR 11 | PN 16

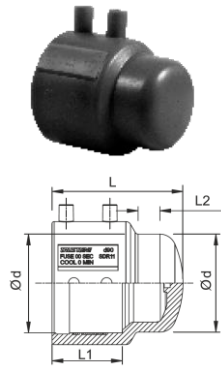

ELECTROFUSION 1P END CAP								
Product Code	d [mm]	L [mm]	L1 [mm]	L2 [mm]	Approx. Wt. gm [pc]	Fusion time (s)	Cooling time (m)	Std packing* [qty]
51181412063	63	96	53	19	174	30	4	42
51181412075	75	100	52	19	218	45	7	36
51181412090	90	120	65	20	380	70	15	22
51181412110	110	140	78	21	647	135	12	10
51181412125	125	149	80	21	870	100	15	8

Material: PE100 | Colour: Black | Terminal Pin: 4.0mm | SDR 11 | PN 16



ELECTROFUSION END CAP							
Product Code	d [mm]	L [mm]	D [mm]	Approx. Wt. gm [pc]	Fusion time (s)	Cooling time (m)	Std packing* [qty]
51181112140	140	156	175	2000	240	20	6
51181112160	160	98	190	2607	380	20	4
51181112180	180	105	215	3416	400	20	3
51181112200	200	112	246	4158	480	30	3
51181112225	225	120	277	6020	690	30	3
51181112250	250	129	292	7740	840	40	2
51181112280	280	139	342	10380	650	40	1
51181112315	315	150	386	14340	840	40	1

TRUSTLENE Electrofusion Fittings

ELECTROFUSION EQUAL TEE

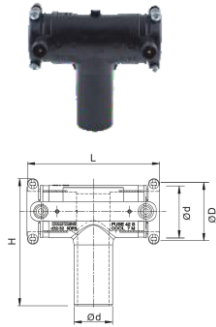

Material: PE100 | Colour: Black | Terminal Pin: 4.0mm | SDR 17 | PN 10

ELECTROFUSION IC EQUAL TEE

Product Code	d [mm]	L [mm]	H [mm]	Approx. Wt. gm [pc]	Fusion time (s)	Cooling time (m)	Std packing* [qty]
51141132020	20	97	88	68	22	4	105
51141132025	25	101	93	79	28	4	90
51141132032	32	110	106	114	42	4	60
51141132040	40	128	122	161	52	7	40
51141132050	50	147	137	250	55	7	24
51141132063	63	152	173	411	70	7	14

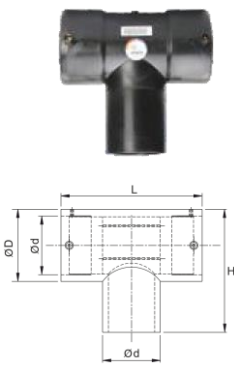

Material: PE100 | Colour: Black | Terminal Pin: 4.0mm | SDR 11 | PN 16

ELECTROFUSION EQUAL TEE

Product Code	d [mm]	L [mm]	H [mm]	D [mm]	Approx. Wt. gm [pc]	Fusion time (s)	Cooling time (m)	Std packing* [qty]
51141112020	20	90	83	32	69	22	4	120
51141112025	25	90	86	35	64	28	4	90
51141112032	32	101	96	45	94	42	4	60
51141112040	40	115	116	53	140	52	7	45
51141112063	63	151	160	82	379	70	7	14
51141112075	75	165	185	94	530	80	7	10
51141112090	90	220	218	113	922	140	7	4
51141112110	110	252	253	137	1384	160	15	3
51141112125	125	256	267	155	2024	200	15	6

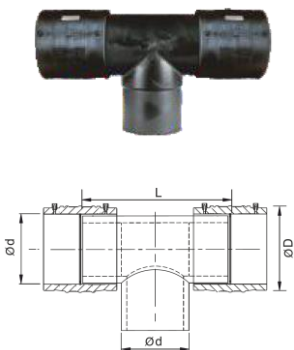

Material: PE100 | Colour: Black | Terminal Pin: 4.0mm | SDR 11 | PN 16

ELECTROFUSION EQUAL TEE (KIT)

Product Code	d [mm]	L [mm]	D [mm]	Approx. Wt. gm [pc]	Fusion time (s)	Cooling time (m)	Std packing* [qty]
51141312140	140	380	165	5185	240	20	2
51141312160	160	417	189	7300	380	20	2
51141312180	180	458	213	9658	400	20	1
51141312200	200	481	236	12030	480	30	1
51141312225	225	527	266	17126	690	30	1
51141312250	250	590	295	22768	840	40	1
51141312280	280	690	331	33164	650	40	1
51141312315	315	712	372	43126	840	40	1

TRUSTLENE Electrofusion Fittings

ELECTROFUSION REDUCING TEE

Material: PE100 | Colour: Black | Terminal Pin: 4.0mm | SDR 11 | PN 16

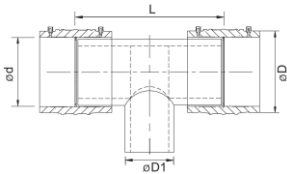

ELECTROFUSION EQUAL TEE (KIT)

Product Code	d [mm]	L [mm]	D [mm]	Approx. Wt. gm [pc]	Fusion time (s)	Cooling time (m)	Std packing* [qty]
51141152191	75 x 63 x75	261	91	964	80	7	4
51141152222	90 x 63 x90	290	113	1782	140	15	4
51141152223	90 x 75 x90	290	113	1826	140	15	4
51141152253	110 x 63 x110	327	138	2916	160	15	3
51141152254	110 x 75 x110	327	138	2954	160	15	3
51141152255	110 x 90 x110	327	138	3020	160	15	3
51141152284	125 x 63 x125	356	155	4040	200	15	3
51141152286	125 x 90 x125	356	155	4300	200	15	3
51141152287	125 x 110 x125	356	155	4382	200	15	3
51141152317	140 x 90 x140	380	165	4848	240	20	3
51141152318	140 x 110 x140	380	165	4976	240	20	3
51141152319	140 x 125 x140	380	165	5046	240	20	2
51141152348	160 x 90 x160	417	189	6504	380	20	2
51141152349	160 x 110 x160	417	189	6830	380	20	2
51141152350	160 x 125 x160	417	189	6924	380	20	2
51141152351	160 x 140 x160	417	189	7008	380	20	2
51141152379	180 x 90 x180	458	213	8818	400	20	1
51141152380	180 x 110 x180	458	213	8950	400	20	1
51141152381	180 x 125 x180	458	213	9086	400	20	1
51141152383	180 x 160 x180	458	213	9346	400	20	1
51141152408	200 x 63 x200	481	236	10710	480	20	1
51141152410	200 x 90 x200	481	236	10740	480	20	1
51141152411	200 x 110 x200	481	236	10864	480	20	1
51141152412	200 x 125 x200	481	236	11004	480	20	1
51141152414	200 x 160 x200	481	236	11360	480	20	1
51141152441	225 x 90 x225	527	266	15728	690	30	1
51141152442	225 x 110 x225	527	266	15750	690	30	1
51141152443	225 x 125 x225	527	266	15930	690	30	1
51141152445	225 x 160 x225	527	266	16120	690	30	1
51141152472	250 x 90 x250	590	295	20428	840	40	1
51141152473	250 x 110 x250	590	295	20690	840	40	1
51141152474	250 x 125 x250	590	295	20630	840	40	1
51141152476	250 x 160 x250	590	295	20950	840	40	1
51141152504	280 x 110 x280	690	331	29490	650	40	1
51141152507	280 x 160 x280	690	331	29786	650	40	1
51141152509	280 x 200 x280	690	331	30532	650	40	1
51141152510	280 x 225 x280	690	331	31300	650	40	1
51141152535	315 x 110 x315	712	372	38806	840	40	1
51141152538	315 x 160 x315	712	372	39920	840	40	1
51141152540	315 x 200 x315	712	372	40360	840	40	1
51141152541	315 x 225 x315	712	372	40980	840	40	1
51141152542	315 x 250 x315	712	372	41480	840	40	1

TRUSTLENE Electrofusion Fittings

ELECTROFUSION WRAP AROUND TAPPING TEE – CLAMP TYPE

Material: PE100 | Colour: Black | Terminal Pin: 4.0mm | SDR 11 | PN 16

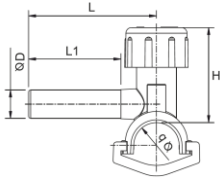

ELECTROFUSION WRAP AROUND TAPPING TEE - SLIDE FIT WRAP

Product Code	d x D [mm]	H [mm]	L [mm]	L1 [mm]	Approx. Wt. gm [pc]	Fusion time (s)	Cooling time (m)	Std packing* [qty]
51161412062	32 x 20	83	90	65	180	30	4	40
51161412093	40 x 20	86	110	78	270	30	4	25
51161412094	40 x 25	86	110	78	270	30	4	25
51161412095	40 x 32	86	110	78	270	30	4	25

Material: PE100 | Colour: Black | Terminal Pin: 4.0mm | SDR 11 | PN 16

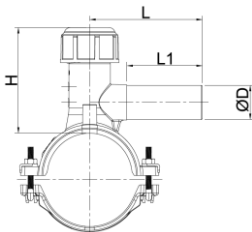

ELECTROFUSION WRAP AROUND TAPPING TEE - CLAMP TYPE

Product Code	d x D [mm]	H [mm]	L [mm]	L1 [mm]	Approx. Wt. gm [pc]	Fusion time (s)	Cooling time (m)	Std packing* [qty]
51161412155	63 x 20	103	106	71	387	70	4	18
51161412156	63 x 25	103	106	71	388	70	4	18
51161412157	63 x 32	103	106	71	395	70	4	18
51161412186	75 x 20	104	106	71	562	100	7	12
51161412187	75 x 25	104	106	71	564	100	7	12
51161412188	75 x 32	104	106	71	568	100	7	12
51161412217	90 x 20	100	106	71	600	100	7	12
51161412218	90 x 25	100	106	71	602	100	7	12
51161412219	90 x 32	100	106	71	606	100	7	12
51161412248	110 x 20	93	106	71	520	95	7	9
51161412249	110 x 25	93	106	71	520	95	7	10
51161412250	110 x 32	93	106	71	520	95	7	10
51161412279	125 x 20	93	106	71	510	95	7	9
51161412280	125 x 25	93	106	71	520	95	7	9
51161412281	125 x 32	93	106	71	535	95	7	9
51161412372	180 x 20	93	106	71	647	95	7	8
51161412373	180 x 25	93	106	71	651	95	7	8
51161412374	180 x 32	93	106	71	653	95	7	8

Material: PE100 | Colour: Black | Terminal Pin: 4.0mm | SDR 11 | PN 16

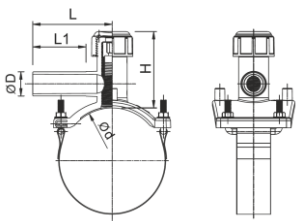

ELECTROFUSION WRAP AROUND TAPPING TEE - BELT TYPE

Product Code	d x D [mm]	H [mm]	L [mm]	L1 [mm]	Approx. Wt. gm [pc]	Fusion time (s)	Cooling time (m)	Std packing* [qty]
51161412310	140 x 20	102	106	71	687	95	7	15
51161412311	140 x 25	102	106	71	687	95	7	15
51161412312	140 x 32	102	106	71	687	95	7	15
51161412341	160 x 20	102	106	71	717	95	7	15
51161412342	160 x 25	102	106	71	717	95	7	10
51161412343	160 x 32	102	106	71	717	95	7	10
51161412403	200 x 20	102	106	71	555	95	7	12
51161412404	200 x 25	102	106	71	555	95	7	12
51161412405	200 x 32	102	106	71	555	95	7	12

TRUSTLENE Electrofusion Fittings

ELECTROFUSION TAPPING TEE

Material: PE100 | Colour: Black | Terminal Pin: 4.0mm | SDR 11 | PN 16

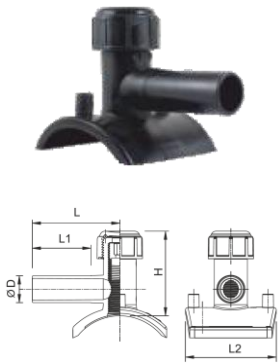

ELECTROFUSION TAPPING TEE

Product Code	d x D [mm]	H [mm]	L [mm]	L1 [mm]	L2 [mm]	Approx. Wt. gm [pc]	Fusion time (s)	Cooling time (m)	Std packing* [qty]
51161113124	50 x 20	78	98	65	113	134	30	4	30
51161113126	50 x 32	78	98	65	113	139	30	4	30
51161313157	63-75-2" x 32	96	106	71	110	271	70	4	24
51161313219	90-3" x 32	96	106	71	110	281	80	4	24
51161313250	110-140-4" x 32	98	106	71	110	358	80	4	24
51161313343	160-200-8" x 32	100	106	71	110	292	80	4	24
51161313236	225-250 x 32	100	130	71	110	286	80	4	24

Material: PE100 | Colour: Black | Terminal Pin: 4.0mm | SDR 11 | PN 16

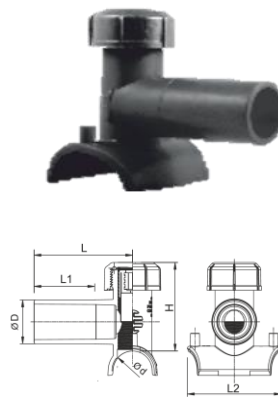

ELECTROFUSION HIGH VOLUME TAPPING TEE

Product Code	d x D [mm]	H [mm]	L [mm]	L1 [mm]	L2 [mm]	Approx. Wt. gm [pc]	Fusion time (s)	Cooling time (m)	Std packing* [qty]
51161113191	75 x 63	168	143	88	136	623	70	4	10
51162113222	90-3" x 63	181	146	90	136	630	70	4	10
51161112160	63 x 63	128	143	88	136	676	70	7	10
51161112222	90 x 63	147	146	88	136	640	70	7	10
51161112253	110 x 63	148	146	88	136	653	70	7	10
51161112284	125 x 63	148	146	88	136	653	70	7	10
51161112377	180 x 63	148	146	88	136	674	70	7	10

ELECTROFUSION BRANCH SADDLE

Material: PE100 | Colour: Black | Terminal Pin: 4.0mm | SDR 11 | PN 16

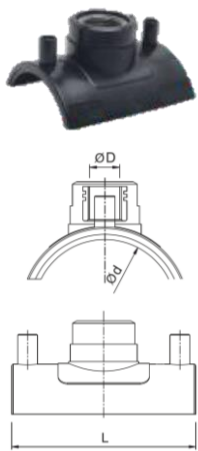

ELECTROFUSION HIGH VOLUME TAPPING TEE

Product Code	d x D [mm]	L [mm]	Approx. Wt. gm [pc]	Fusion time (s)	Cooling time (m)	Std packing* [qty]
51171114146	50 x 1/2"	120	140	30	4	86
51171234177	63 - 75 x 1/2"	120	233	70	4	60
51171234178	63 - 75 x 3/4"	120	275	70	4	60
51171234179	63 - 75 x 1"	120	275	70	4	50
51171234239	90 - 140 x 1/2"	120	181	80	4	60
51171234240	90 - 140 x 3/4"	120	183	80	4	60
51171234241	90 - 140 x 1"	120	231	80	4	60

TRUSTLENE Electrofusion Fittings

ELECTROFUSION BRANCH SADDLE

Material: PE100 | Colour: Black | Terminal Pin: 4.0mm | SDR 11 | PN 16



ELECTROFUSION BRANCH SADDLE WITH BOTTOM WRAP

Product Code	d x D [mm]	L [mm]	Approx. Wt. gm [pc]	Fusion time (s)	Cooling time (m)	Std packing* [qty]
51171332177	63 x 1/2"	125	170	80	4	40
51171332208	75 x 1/2"	120	264	100	4	30
51171332239	90 x 1/2"	140	300	100	4	25
51171332270	110 x 1/2"	160	320	100	4	20

ELECTROFUSION TRANSITION COUPLER

Material: PE100 | Colour: Black | Terminal Pin: 4.0mm | SDR 11 | PN 16

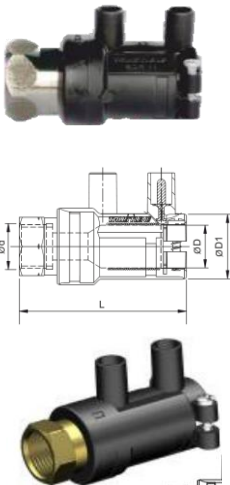

ELECTROFUSION IC METAL TRANSITION COUPLER (BSPT)

Product Code	d x D [mm]	L [mm]	D1 [mm]	Metal Type	Approx. Wt. gm [pc]	Fusion time (s)	Cooling time (m)	Std packing* [qty]
51271232022	20 x 1/2"	80	31	Stainless steel	147	19	4	100
51271232023	20 x 3/4"	80	31	Stainless steel	170	19	4	100
51271232084	32 x 1/2"	83	44	Stainless steel	163	28	4	60
51271232085	32 x 3/4"	83	44	Stainless steel	163	28	4	60
51271232086	32 x 1"	88	44	Stainless steel	258	28	4	60

ELECTROFUSION IC METAL TRANSITION COUPLER (BSPT)

Product Code	d x D [mm]	L [mm]	D1 [mm]	Metal Type	Approx. Wt. gm [pc]	Fusion time (s)	Cooling time (m)	Std packing* [qty]
51271272022	20 x 1/2"	78	31	Brass	106	19	4	100

WELDABLE TRANSITION FITTING (STEEL-PE)

Material: PE100 / Carbon steel | SDR 11 | PN 16



ELECTROFUSION IC METAL TRANSITION COUPLER (STEEL - PE)

Product Code	d x D [mm]	L [mm]	L1 [mm]	L2 [mm]	Metal Type	Approx. Wt. kg [pc]
51271712032	32 x 1"	400	100	300	Carbon Steel	1.2
51271712090	90 x 3"	510	190	320	Carbon Steel	6.2
51271712125	125 x 4"	510	190	320	Carbon Steel	10.5
51271712160	160 x 6"	630	200	430	Carbon Steel	18.3
51271712180	180 x 6"	630	200	430	Carbon Steel	18.7

TRUSTLENE Electrofusion Fittings

BRASS SPIGOT TRANSITION FITTING

Material: PE100 / Brass | Colour: Black | SDR 11 | PN 16

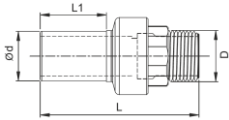

BRASS SPIGOT TRANSITION FITTING - MALE (BSPT)					
Product Code	d x D [mm]	L [mm]	L1 [mm]	Approx. Wt. gm [pc]	Std packing* [qty]
51271182022	20 x 1/2"	97	43	118	50
51271182023	20 x 3/4"	97	43	127	50
51271182054	25 x 3/4"	97	43	147	50
51271182086	32 x 1"	103	43	233	50
51271182118	40 x 1 1/4"	126	53	374	45
51271182153	50 x 1 1/2"	133	61	437	40
51271182181	63 x 2"	139	43	698	25

Material: PE100 / Brass | Colour: Black | SDR 11 | PN 16

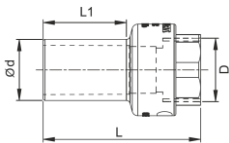

BRASS SPIGOT TRANSITION FITTING - FEMALE (BSPT)					
Product Code	d x D [mm]	L [mm]	L1 [mm]	Approx. Wt. gm [pc]	Std packing* [qty]
51271172022	20 x 1/2"	81	43	94	50
51271172054	25 x 3/4"	81	43	116	50
51271172086	32 x 1"	83	43	171	50
51271172118	40 x 1 1/4"	104	53	310	45
51271172153	50 x 1 1/2"	111	61	365	40
51271172181	63 x 2"	115	63	541	25

TRUSTLENE Electrofusion Fittings

ELECTROFUSION COUPLER + BRASS SPIGOT TRANSITION FITTING



Material: PE100 / Brass | Colour: Black | SDR 11 | PN 16

ELECTROFUSION BRASS TRANSITION COUPLER - MALE

Product Code	d x D [mm]	L [mm]	L1 [mm]	L2 [mm]	L3 [mm]	Approx. Wt. gm [pc]	Fusion time (s)	Cooling time (m)
51271382022	20 x 1/2"	137	97	60	38	171	22	4
51271382023	20 x 3/4"	137	97	60	38	180	22	4
51271382054	25 x 3/4"	138	97	59	39	210	28	4
51271382086	32 x 1"	145	103	63	40	308	42	4
51271382118	40 x 1 1/4"	167	126	73	42	470	52	7
51271382153	50 x 1 1/2"	185	133	72	53	578	55	7
51271382185	63 x 2"	190	139	90	49	918	70	7

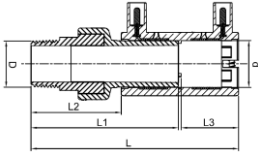

Material: PE100 / Brass | Colour: Black | SDR 11 | PN 16

ELECTROFUSION BRASS TRANSITION COUPLER - FEMALE

Product Code	d x D [mm]	L [mm]	L1 [mm]	L2 [mm]	L3 [mm]	Approx. Wt. gm [pc]	Fusion time (s)	Cooling time (m)
51271372022	20 x 1/2"	121	81	38	38	147	22	4
51271372054	20 x 3/4"	121	81	38	38	156	22	4
51271372086	32 x 1"	125	83	43	40	246	42	4
51271372118	40 x 1 1/4"	146	104	51	42	406	52	7
51271372153	50 x 1 1/2"	164	111	50	53	506	55	7
51271372185	63 x 2"	166	115	52	49	761	70	7

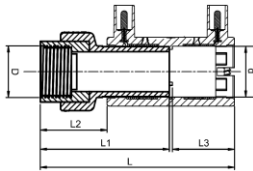

ELECTROFUSION ELBOW 90° + BRASS SPIGOT TRANSITION FITTING



Material: PE100 / Brass | Colour: Black | SDR 11 | PN 16

ELECTROFUSION BRASS TRANSITION ELBOW - 90° MALE

Product Code	d x D [mm]	L [mm]	L1 [mm]	L2 [mm]	L3 [mm]	Approx. Wt. gm [pc]	Fusion time (s)	Cooling time (m)
51271482022	20 x 1/2"	136	97	60	38	181	22	4
51271482023	20 x 3/4"	136	97	60	38	190	22	4
51271482054	25 x 3/4"	135	97	59	39	220	28	4
51271482086	32 x 1"	149	103	63	40	323	42	4
51271482118	40 x 1 1/4"	176	126	72	51	515	52	7
51271482153	50 x 1 1/2"	190	133	71	58	572	55	7
51271482185	63 x 2"	220	139	90	49	1013	70	7

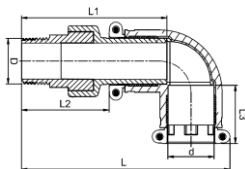

Material: PE100 / Brass | Colour: Black | SDR 11 | PN 16

ELECTROFUSION BRASS TRANSITION ELBOW - 90° FEMALE

Product Code	d x D [mm]	L [mm]	L1 [mm]	L2 [mm]	L3 [mm]	Approx. Wt. gm [pc]	Fusion time (s)	Cooling time (m)
51271472022	20 x 1/2"	120	81	38	38	157	22	4
51271472054	25 x 3/4"	121	81	38	39	186	28	4
51271472086	32 x 1"	126	83	43	40	261	42	4
51271472118	40 x 1 1/4"	155	104	51	51	451	52	7
51271472153	50 x 1 1/2"	169	111	50	58	500	55	7
51271472185	63 x 2"	196	115	66	49	856	70	7

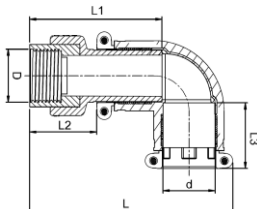

TRUSTLENE Electrofusion Fittings

ELECTROFUSION ELBOW 45° + BRASS SPIGOT TRANSITION FITTING

Material: PE100 / Brass | Colour: Black | SDR 11 | PN 16

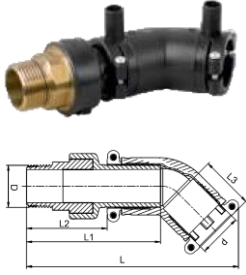

ELECTROFUSION BRASS TRANSITION ELBOW - 45° MALE

Product Code	d x D [mm]	L [mm]	L1 [mm]	L2 [mm]	L3 [mm]	Approx. Wt. gm [pc]	Fusion time (s)	Cooling time (m)
51271582022	20 x 1/2"	147	97	60	43	173	22	4
51271582023	20 x 3/4"	147	97	60	43	182	22	4
51271582054	25 x 3/4"	155	97	59	48	219	28	4
51271582086	32 x 1"	164	103	63	40	318	42	4
51271582118	40 x 1 1/4"	184	126	73	58	499	52	7
51271582153	50 x 1 1/2"	197	133	72	65	618	55	7
51271582185	63 x 2"	215	139	90	77	1001	70	7

Material: PE100 / Brass | Colour: Black | SDR 11 | PN 16

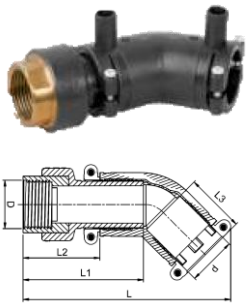

ELECTROFUSION BRASS TRANSITION ELBOW - 45° FEMALE

Product Code	d x D [mm]	L [mm]	L1 [mm]	L2 [mm]	L3 [mm]	Approx. Wt. gm [pc]	Fusion time (s)	Cooling time (m)
51271572022	20 x 1/2"	131	81	38	43	149	22	4
51271572054	25 x 3/4"	139	81	38	43	188	28	4
51271572086	32 x 1"	144	83	43	40	256	42	4
51271572118	40 x 1 1/4"	162	104	51	58	435	52	7
51271572153	50 x 1 1/2"	176	111	50	65	546	55	7
51271572185	63 x 2"	191	115	52	76	844	70	7

ELECTROFUSION REDUCER + BRASS SPIGOT TRANSITION FITTING

Material: PE100 / Brass | Colour: Black | SDR 11 | PN 16



ELECTROFUSION BRASS TRANSITION REDUCER - MALE

Product Code	d x D [mm]	L [mm]	Approx. Wt. gm [pc]	Fusion time (s)	Cooling time (m)
51270682053	25 x 1/2"	141	180	26	4
51271682084	32 x 1/2"	143	193	34	4
51271682085	32 x 3/4"	143	222	30	4
51271682116	40 x 3/4"	154	239	30	7

Material: PE100 / Brass | Colour: Black | SDR 11 | PN 16



ELECTROFUSION BRASS TRANSITION REDUCER - FEMALE

Product Code	d x D [mm]	L [mm]	Approx. Wt. gm [pc]	Fusion time (s)	Cooling time (m)
51271672054	25 x 1/2"	147	156	26	4
51271672117	40 x 1"	137	268	42	7
51271672147	50 x 3/4"	138	219	30	7
51271672149	50 x 1 1/4"	161	428	46	7
51271672184	63 x 1 1/2"	170	570	45	7

TRUSTLENE® Electrofusion High Volume Tapping Tee - 63mm Outlet [Bottom Wrap Type]

PE100 Electrofusion High Volume Tapping Tee for Use with PE Pipes

The high-volume tapping tee is manufactured from PE100 polyolefin and incorporates a precisely molded energizing coil, ensuring uniform fusion and a strong, reliable joint on the main pipeline.

Designed for a permanent and secure connection, the tapping tee uses the electrofusion process—a proven technology that joins high-density polyethylene (HDPE) components by creating a molecular bond between the pipe and the fitting.

This high-volume tapping tee features a 63 mm outlet specifically engineered for pipeline branching. The fittings are rated to PN16 for water applications and 1000 kPa for gas applications.

Each product is supplied with a bottom wrap that secures the fitting, ensuring continuous and positive contact with the pipe surface, as well as correct alignment before and during the fusion process.

Applications: Water & Gas



PE100 Electrofusion High Volume Tapping Tee - Bottom Wrap [PN16]

Size [mm]	SDR	Material	Cutter Material	Pin Type
90 x 63	11	PE100	Brass cutter	4.0mm
125 x 63	11	PE100	Brass cutter	4.0mm
160 x 63	11	PE100	Brass cutter	4.0mm
180 x 63	11	PE100	Brass cutter	4.0mm
200 x 63	11	PE100	Brass cutter	4.0mm